

# MODEL PART DIAGRAM

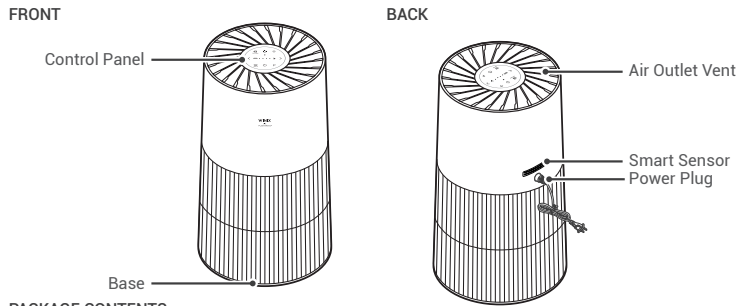

## PACKAGE CONTENTS

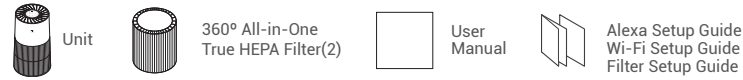

\* For a Certified Refurbished Air Purifier, there will be 1 360° All-in-One True HEPA Filter included; equivalent to a 1-year supply.

## WHERE TO USE

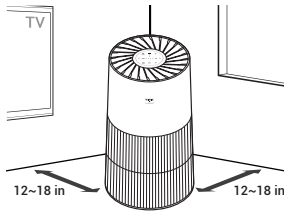

Allow 12 ~ 18 in. of space between TVs, radios, and other electronics. Electromagnetic interference from certain electronics may cause product malfunction.

Place indoors away from direct sunlight. Direct exposure may cause product malfunction or failure.

Only place on hard, flat surfaces. Flimsy or slanted surfaces may result in abnormal noise and vibrations.

Allow at least 12 ~ 18 in. from walls for maximum air flow

## 4-STAGE AIR PURIFICATION

Air Purification means it removes inanimate particles

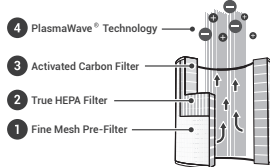

## INITIAL OPERATION

- Turn the product upside down.
- Grab the handle at the bottom of the product, turn counter clockwise, and pull out the filter cover.
- Turn the upper CAP of the filter counter clockwise to separate it.
- After disassembling the filter cover, remove the protective vinyl in the filter.
- After reassembling the filter, close the filter cover. (When assembling the filter cover, insert it according to the direction of the square hole)
- Assemble the filter top cap by turning it clockwise.
- After installing the filter, turn the handle clockwise to close the filter cover.
- Return the product to an upright position and resume normal operation.

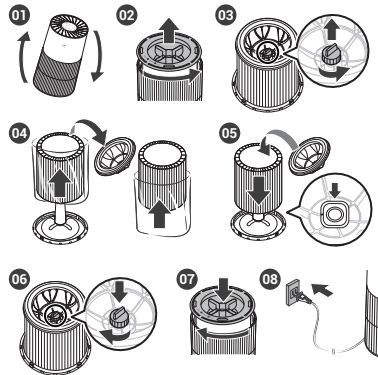

## MAINTENANCE

### When to Replace Filters

Filter	Indicator Light	When to Service	When to Replace
360° All-in-One True HEPA Filter	Check Filter	Clean once every 14 days	Lasts Approx. 12 months

- When the Check Filter indicator LED is on, it is time to replace the 360° All-in-One True HEPA Filter.
- Intervals between filter replacement may vary depending on environment.

## REPLACING FILTERS



**Resetting Filter Life:**  
After replacing the 360° All-in-One True HEPA Filter, use a small object such as a While the unit is on, hold the Filter Reset Button for at least 5 seconds until you hear the beep. After the beep, the Filter Replacement Indicator will disappear.



## CONTROL PANEL

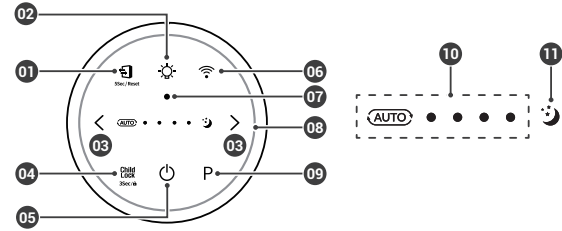

### 01. Filter Reset Button / Indicator

- After replacing the 360° All-in-One True HEPA Filter, press and hold the Filter Reset Button for at least 5 seconds until the Filter Replacement Indicator turns off.
- LED light indicates when it is time to change the filter.

### 02. Light Mode Button

Use the light button to set the desired display brightness. The display brightness cycles in the order of 100% → 70% → 30% → OFF. Other features remain unchanged.

### 03. Fan Speed Indicator Buttons

Indicates the current fan speed.

- Use the Fan Speed arrow buttons to set the desired fan speed. Fan speeds cycle over in this sequence: Auto, Low, Medium, High, Turbo, Sleep

### 04. Child Lock Button / Indicator

- Child Lock Button for 3 seconds, Child Lock will be initiated and the buttons will not operate. A chime will sound if pressed. To cancel, press the child lock button for 3 seconds.
- LED light indicates whether Child Lock mode is enabled or disabled.

### 05. Power Button

Turns the unit on or off. During the first 30 seconds of power, the Air Quality Indicator will cycle through Blue, Green, Amber and Red colors.

- Smart Sensor takes approximately 30 seconds to detect the air quality in the environment before normal operation begins.

### 06. Wi-Fi Pairing Button / indicator

- A quick press will turn Wi-Fi on/off.
- A long press of 3 seconds will activate pairing mode.
- A Wi-Fi indicator will display on the front while Wi-Fi is active.
- Indicates whether Wi-Fi Mode is enabled or disabled.

### 07. Light Sensor

Detects the amount of ambient light in the environment. When in Auto Mode, the light sensor detects when to put the unit into Sleep Mode.

### 08. Air Quality Indicator

Color coded LED light indicates one of four levels of Air Quality: Red (poor), Amber (fair), Green (average) and Blue (good).

### 09. PlasmaWave® Button / Indicator

- Enables or disables PlasmaWave®

When the unit is running, you may hear a chirping or buzzing sound. The sound is from particles passing through. PlasmaWave®, it is normal and does not signify product failure. Press the PlasmaWave® Technology button when the unit is on to enable or disable this feature.

- Indicates whether PlasmaWave® is enabled or disabled.

### 10. Mode Indicator

Indicates whether Auto & Fan Speed Mode is enabled or disabled.



### 11. Sleep Mode Indicator

Indicates whether Sleep Mode is enabled or disabled.

## CLEANING CARE

### Cleaning the Filters:

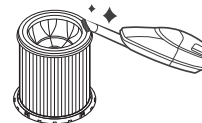

- Clean with a vacuum or a soft brush.
- Only clean the Pre-Filter.
- This filter CAN NOT be washed.
- Intervals between filter cleaning may vary depending on the air quality.

### Cleaning the Exterior & Interior:

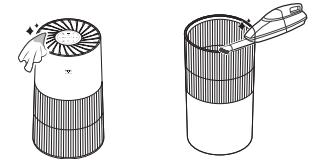

- Wipe with a soft damp cloth using room temperature water.
- Afterwards, wipe it down with a dry cloth.
- Open the front panel and clean the interior with a vacuum cleaner.
- For optimal performance, clean every 1 - 2 months.

### NOTICE

- When cleaning the unit, always unplug the power cord first and then wait until the unit has cooled down.
- Never disassemble, repair, or modify this unit yourself.
- Do not use flammable sprays or liquid detergents.
- Do not allow children to clean or maintain the unit.
- Before cleaning or maintaining, ensure unit is unplugged.
- Do not use benzene, alcohol, or other volatile fluids, which may cause damage or discoloration.

## SPECIFICATIONS

Model	C610
Voltage	AC 120 V / 60 Hz
Power Rate	45 W
Dimensions	10.45" W x 10.45" D x 18.54" H
Weight	7.7 lbs
Filter SKU	Filter Z: 1712-0121-00

Exterior design, and product specifications may be changed without prior notice to improve product performance.

### Contact Winix for product related inquiries and customer service

- Dedicated Call Center: ☎ (877) 699-4649
- Website: [www.winixamerica.com](http://www.winixamerica.com)

To expedite service, please specify the model name and number, the nature of the problem, your contact information, and your address.

For Troubleshooting or Frequently Asked Questions, please visit: <https://winixamerica.com/faq/>

## SAFETY AND CAUTIONS

Before operating this equipment, carefully read and follow these safety cautions.

**Ensure filters are inserted before running unit.** Running the unit without filters can shorten the lifespan of the unit and cause electric shock or injury.

**Be sure foreign objects are NOT inserted into the vents on the unit.** Objects can include pins, rods, and coins.

**Do not touch any part of the interior of the unit with wet hands.** The high voltage may cause electric shock.

**Ensure unit intake and outlet vents do not become blocked.** Blockage may lead to increased internal temperatures, causing product failure and deformation.

**Do not use the unit as a step stool or place heavy objects on the unit.** Personal injury may occur or product failure and deformation.

- ⚠ Do not place below any electrical outlet.
- ⚠ Do not have the unit facing into wind or drafts.
- ⚠ Do not pull on the power cord when unplugging the unit.
- ⚠ Do not tie or knot the power cord when unit is in operation.
- ⚠ If the unit becomes submerged in water, unplug it and contact customer service.
- ⚠ Do not unplug or move the unit while in operation.
- ⚠ Do not plug additional appliances into the same outlet or power supply.
- ⚠ Do not touch the plug with wet hands.
- ⚠ Unplug the unit when not in operation for extended periods of time.
- ⚠ Do not place around heating elements.

**⚠ WARNING**  
Follow these instructions to reduce the risk of serious injury or death and to reduce risk of damaging the unit.

- If the power cord is damaged, it must be replaced by a special cord. Reassembly is available from the manufacturer or its service agent.
- This appliance is not intended for use by a person (including children) with reduced physical sensory or mental capabilities, or lack of experience and knowledge of the unit, unless they have been given supervision or instruction concerning use of the appliance by a person responsible for their safety.
- Children should be supervised to ensure that they do not play with the appliance.
- This unit is not intended to be used to preserve documents or art conservation.

- ⚠ The cord can become damaged by forcefully bending, pulling, twisting, bundling, pinching or placing heavy objects on the cord.
- ⚠ Do not install in any sort of motor or transport vehicle (trucks, boats, ships, etc.).
- ⚠ Do not place in an area with excessive amounts of noxious gases.
- ⚠ Do not place near any flammable materials (aerosols, fuel, gases, etc.).
- ⚠ Do not place in excessively humid areas where the unit may become wet.
- ⚠ Do not place unit closer than 12 inches from the wall during operation. It may cause condensation on the wall and the surrounding area.
- ⚠ Do not use around mist or fumes from industrial oil or around large quantities of metallic dust.

## 2 YEAR LIMITED WARRANTY For more warranty information visit: <https://winixamerica.com/terms-and-conditions/>

The terms of the limited warranty are as follows:

01. This product is manufactured under stringent quality control and inspections.
02. The limited warranty will be voided if product failure is a result of negligence or misuse by the consumer.
03. A proof of purchase must be presented upon claiming a limited warranty.
04. Store the proof of purchase in a safe place or register your product on winixamerica.com to upload your proof of purchase.
05. This limited warranty is valid only in the USA and Canada.

\* Certified Refurbished Air Purifiers come with a 1-year warranty. All Winix Certified Refurbished Air Purifiers go through a detailed inspection and refurbishment process to ensure all quality and performance standards are met.

Warning: Changes or modifications to this unit not expressly approved by the party responsible for compliance could void the user's authority to operate the equipment.

Note: This equipment has been tested and found to comply with the limits for a Class B digital device, pursuant to Part 15 of the FCC Rules. These limits are designed to provide reasonable protection against harmful interference in a residential installation. This equipment generates, uses and can radiate radio frequency energy and, if not installed and used in accordance with the instructions, may cause harmful interference to radio communications. However, there is no guarantee that interference will not occur in a particular installation. If this equipment does cause harmful interference to radio or television reception, which can be determined by turning the equipment off and on, the user is encouraged to try to correct the interference by one or more of the following measures:

- Reorient or relocate the receiving antenna.
- Increase the separation between the equipment and receiver.
- Connect the equipment into an outlet on a circuit different from that to which the receiver is connected.
- Consult the dealer or an experienced radio/TV technician for help.

This device contains license-exempt transmitter(s)/receiver(s) that comply with Innovation, Science and Economic Development Canada's license-exempt RSS(s). Operation is subject to the following two conditions:

- This device may not cause interference.
- This device must accept any interference, including interference that may cause undesired operation of the device.

In French: L'émetteur/récepteur exempt de licence contenu dans le présent appareil est conforme aux CNR d'Innovation, Sciences et Développement économique Canada applicables aux appareils radio exempts de licence. L'exploitation est autorisée aux deux conditions suivantes :

- L'appareil ne doit pas produire de brouillage;
- L'appareil doit accepter tout brouillage radioélectrique subi, même si le brouillage est susceptible d'en compromettre le fonctionnement.

## SAFETY INSTRUCTIONS

Read and save these instructions.

Thank you for purchasing a Winix air purifier. This product is for household use only.

### IMPORTANT CAUTIONS FOR USING YOUR AIR PURIFIER:

#### WARNING:

Follow the instructions in this manual to reduce the risk of electric shock, short circuit, and/or fire.

- Do not repair or modify the unit. All repairs should be completed by a qualified technician.
- The plug for this unit is polarized with one blade wider than the other. Do not force the plug into an electrical outlet. Do not alter the plug in any way. If the plug does not fit into the outlet, reverse the plug. If it still does not fit, contact a qualified technician to install a proper outlet.
- Do not use if the power cord or plug is damaged or the connection to the wall outlet is loose.
- Use AC 120V only.
- Do not damage, break, forcefully bend, pull, twist, bundle, coat, pinch, or place heavy objects on the power cord.
- Periodically remove dust from the power plug. This will reduce the risk of shock due to humidity build up.
- Remove the power plug from the outlet before cleaning the unit. When removing the power plug, grasp by holding the plug itself, never hold by the cord.
- If the power plug is damaged, it must be replaced by the manufacturer or a qualified technician.
- Remove the power plug from the outlet when not in use.
- Do not handle the power plug with wet hands.
- Do not operate the unit when using indoor smoke-generating insecticides.
- Do not clean unit with benzene or paint thinner. Do not spray insecticides on the unit.
- Do not use the unit where it is humid or where the unit may become wet, such as the bathroom.
- Do not insert fingers or foreign objects into air intake or outlet.
- Do not use the unit near flammable gases. Do not use near cigarettes, incense, or other spark-creating items.
- Unit will not remove carbon monoxide emitted from heating appliances or other sources.
- Unplugging the product disconnects the remote functions.

#### IMPORTANT PRECAUTIONS FOR USING YOUR AIR PURIFIER:

- Do not block the intake or outlet vents.
- Do not use near hot objects, such as a stove.
- Do not use where the unit may come into contact with steam.
- Do not use the unit on its side.
- Keep away from products that generate oily residue, such as a deep fryer.
- Do not use detergent to clean the unit.
- Do not operate without a filter.
- Do not wash and reuse the True HEPA Filter.
- Hold the handle on the back of the unit to transport.
- Do not hold by the front panel.
- Do not stick any small objects into the air outlet vents or fan.

# WINIX AIR PURIFIER

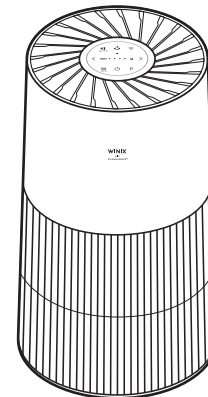

## C610 USER MANUAL



The energy efficiency of this ENERGY STAR certified model is measured based on a ratio between the model's CADR for smoke and the electrical energy it consumes, or CADR/Watt.

- The product warranty is printed on the back of this guide. This product is manufactured for use only in USA / Canada. This product is suitable for 120 V only.